

Getting Started  
With Your

# N5L

nuu  
mobile

www.nuumobile.com

## N5L Overview

EN

### Front/Back

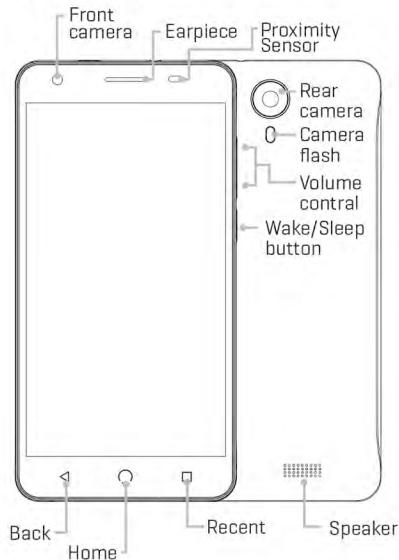

### Top



### Bottom

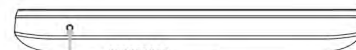

## Setting up Your Phone

Follow these step-by-step instructions to set up your N5L.  
Power off the phone and remove battery **before** inserting any cards!

- 1 Remove Back Cover**
  - Remove the back cover by prying the upper corner of your device with your fingers.
- 3 Insert SIM (Dual SIM Standby)**
  - Orient SIM card to match diagram on slot.
  - SIM 1 (Micro) supports 4GLTE connections.
  - SIM 2 (Micro) supports 4GLTE connections.

- 2 Insert microSD™ Memory Card**
  - Power off the phone and remove battery before inserting memory card.

- 4 Insert the Battery**
  - Align the battery contacts, then insert the battery contact-first.

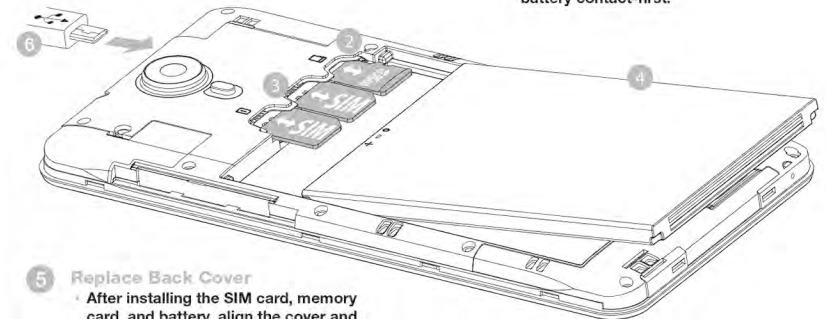

- 5 Replace Back Cover**
  - After installing the SIM card, memory card, and battery, align the cover and snap it closed. Make sure you press all around the edge to ensure a secure fit.
- 6 Charge/Sync**
  - Plug in the microUSB connector to charge the phone or transfer data.

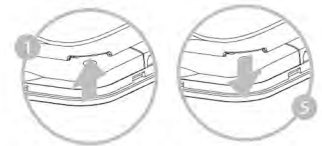

**Warning:** SIM cards are small enough to become a choking hazard, so please keep them away from children. SIM cards are also quite delicate. Please be careful when handling your card.